

# FAST START

GUIDE

# FAST START

GUIDE

Read and understand all instruction, warning and danger labels.

Lea el manual de operación anexo sobre ensamblaje e inicio.

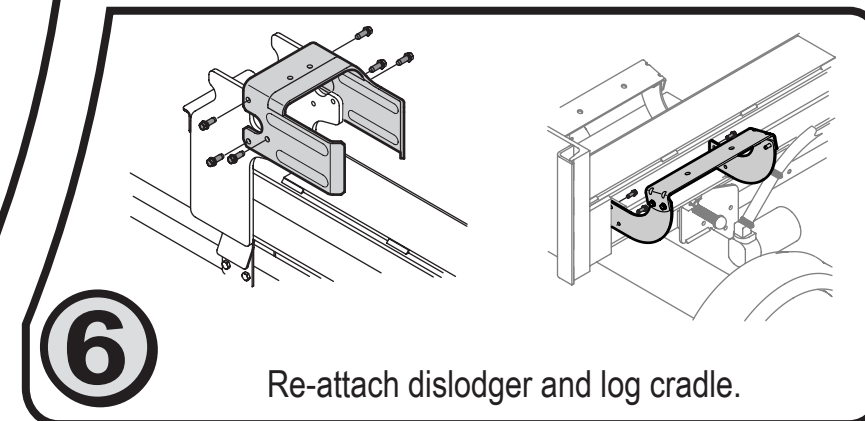
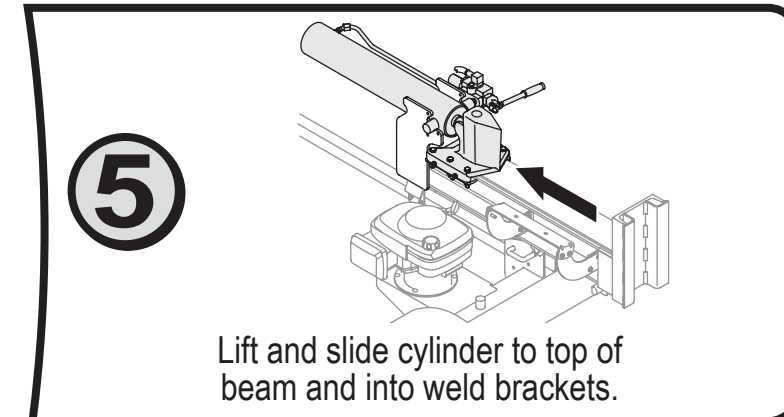
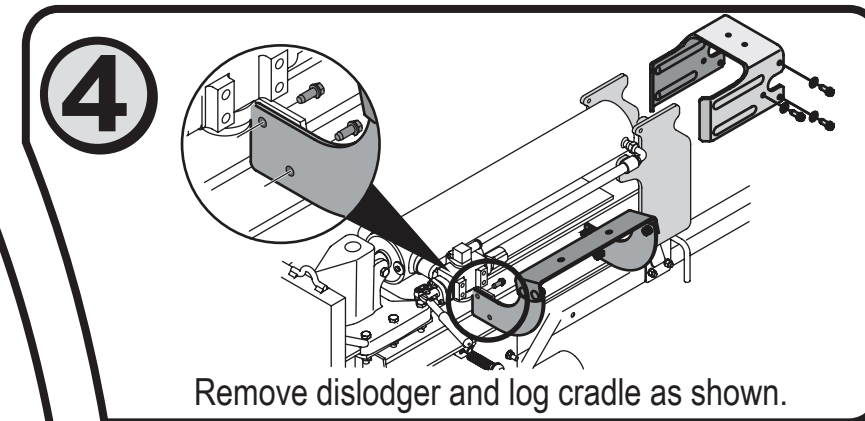
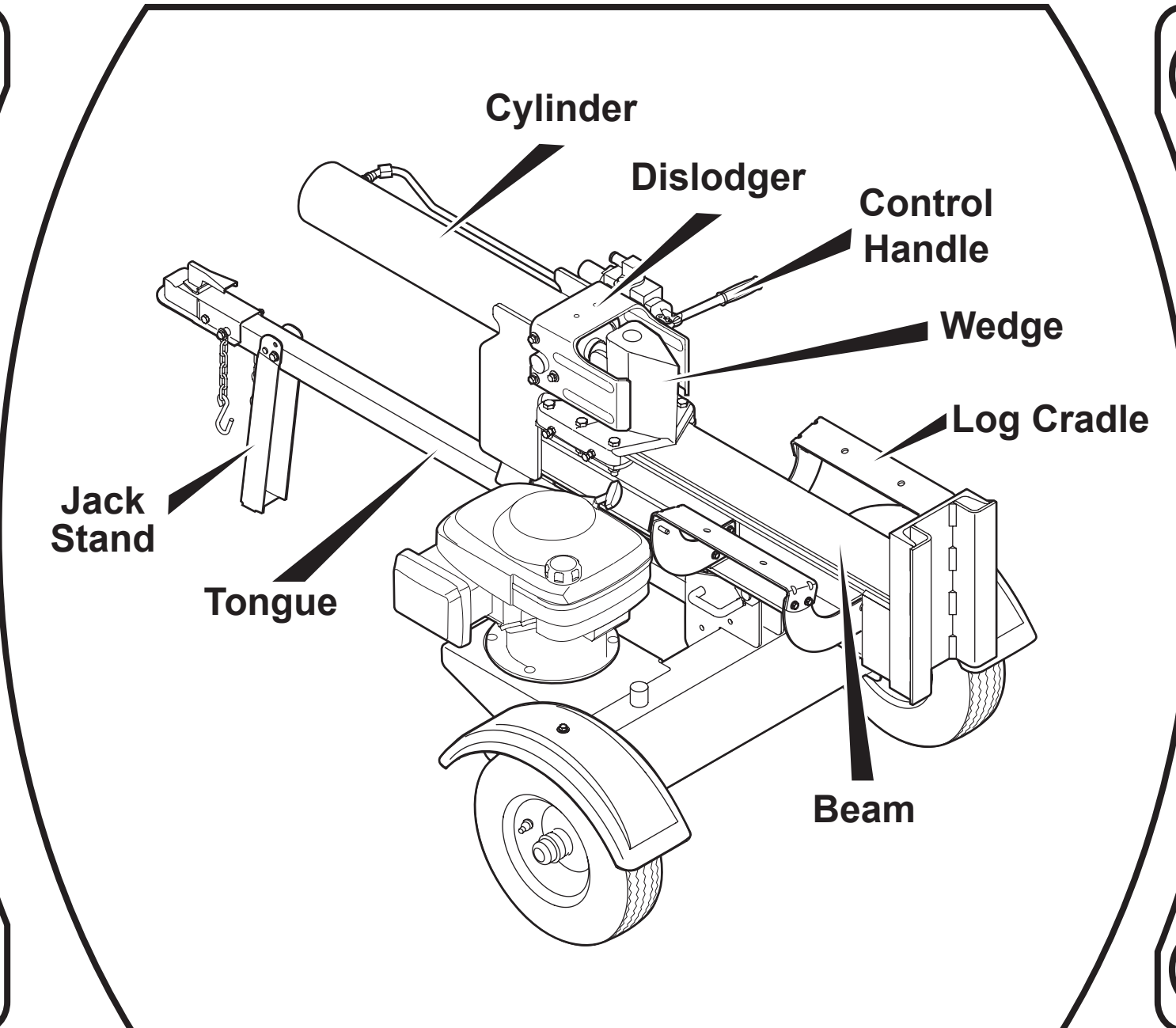
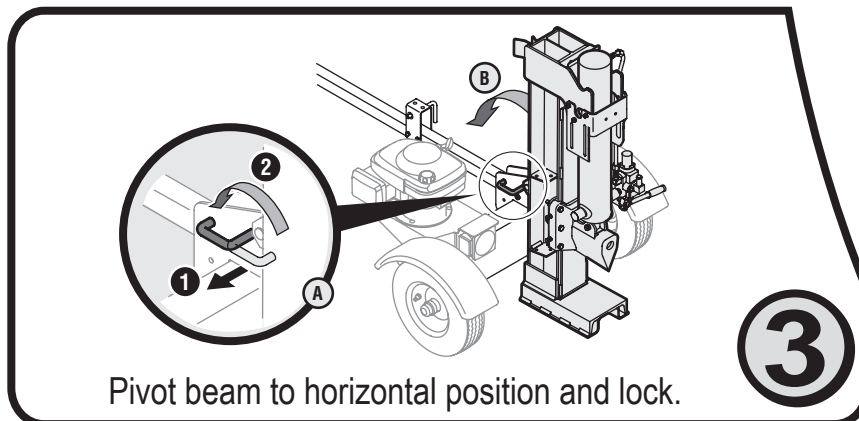
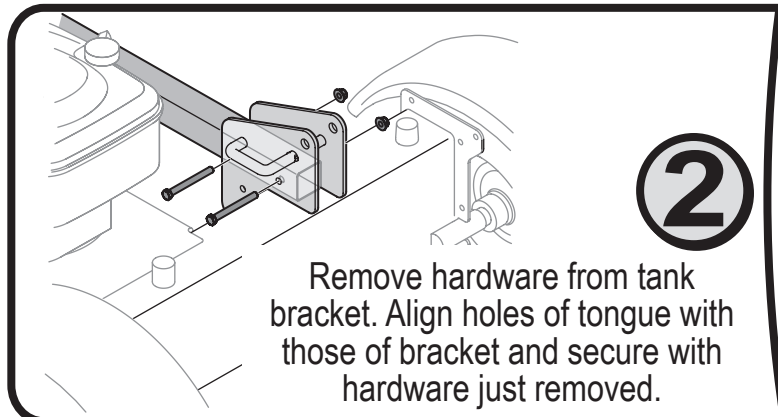
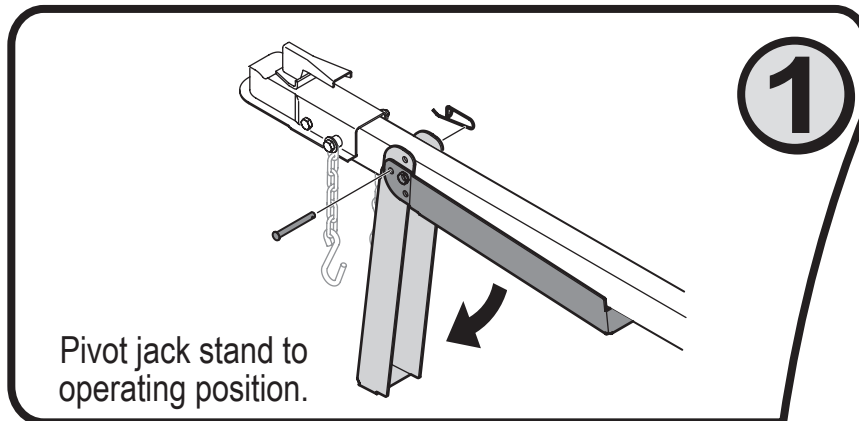

**IMPORTANT: READ OPERATOR'S MANUAL THOROUGHLY AND FOLLOW THE SAFE OPERATION PRACTICES BEFORE OPERATING.**



# FAST START

## GUIDE

# FAST START

## GUIDE

Read and understand all instruction, warning and danger labels.

Lea el manual de operación anexo sobre ensamblaje e inicio.

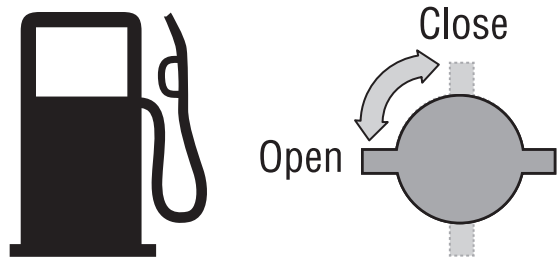

7

Fill tank with gas to within 1/2 inch of top of tank.  
Open fuel valve.

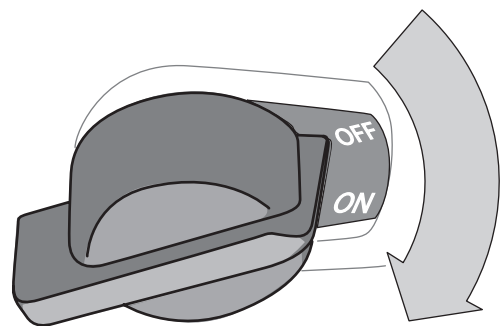

8

Turn engine switch to ON position.

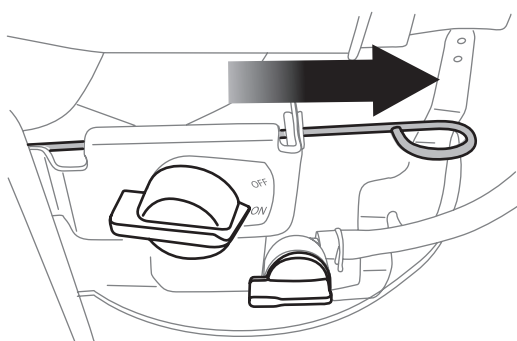

9

Pull CHOKE out.

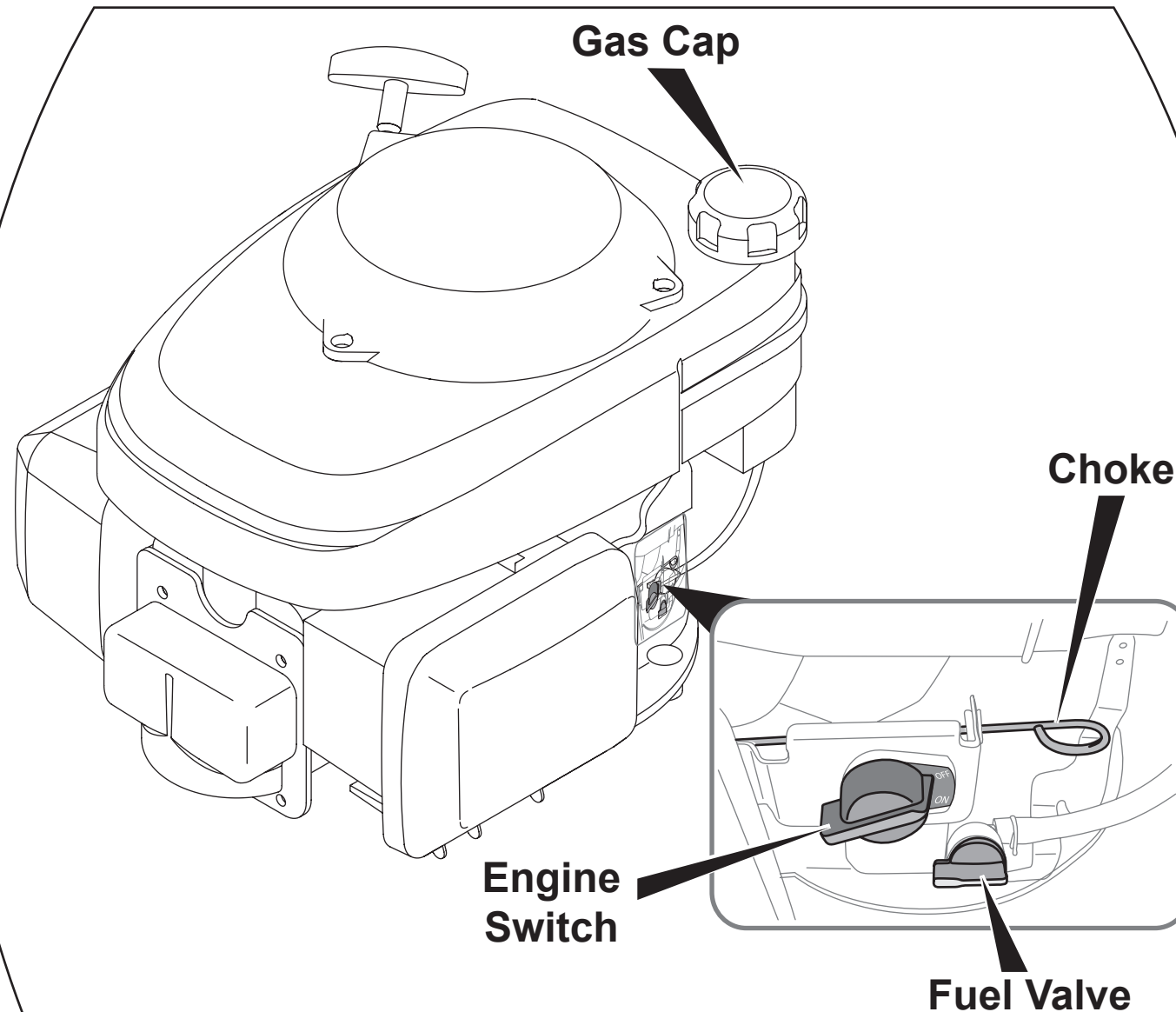

Need Help?

**Call 1-800-800-7310**

10

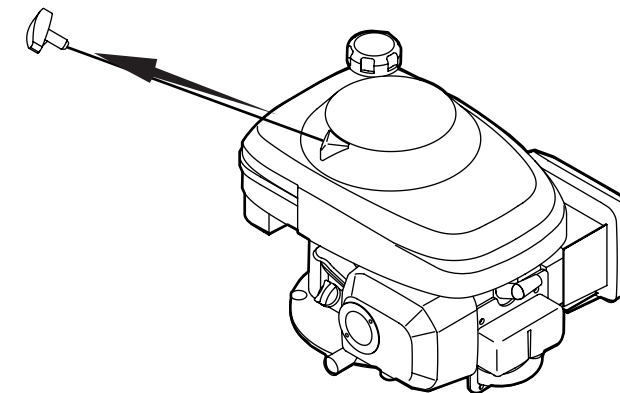

Pull starter rope with quick, full armstroke. If engine does not start after ten seconds of repeated pulls, repeat steps seven through ten.

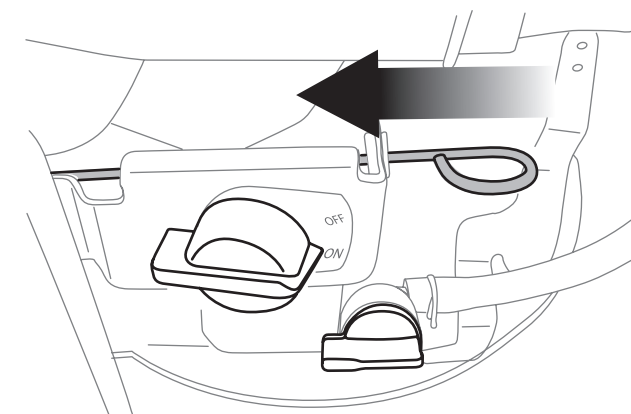

11

Push CHOKE in once engine starts.



**IMPORTANT: READ OPERATOR'S MANUAL THOROUGHLY AND FOLLOW THE SAFE OPERATION PRACTICES BEFORE OPERATING .**

