

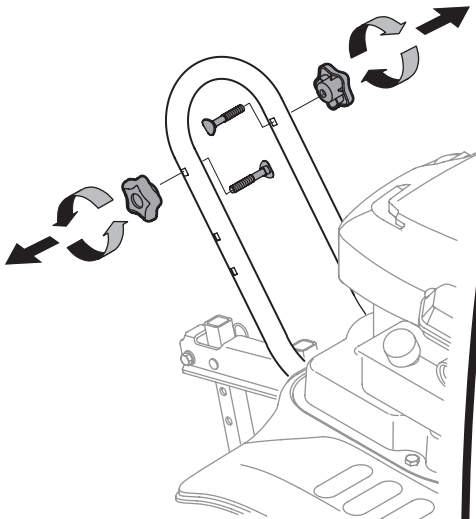

READ AND UNDERSTAND ALL INSTRUCTION, WARNING, AND DANGER LABELS.  
PARA INSTRUCCIONES EN ESPAÑOL, REFIÉRASE AL MANUAL DEL OPERADOR.



- 1 Remove bolts and star knobs from lower handle.



- 2 A. Attach upper handle to lower handle using removed hardware  
B. Tighten star knobs securely.

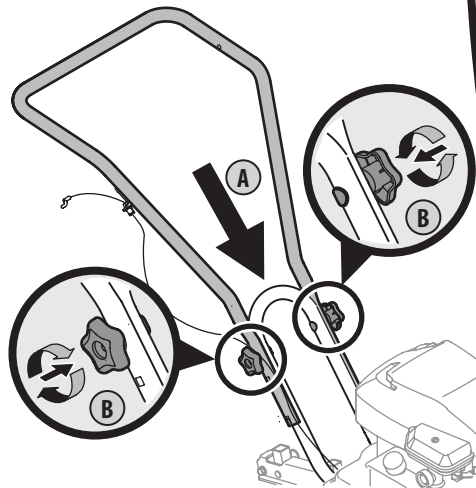

# FAST START GUIDE

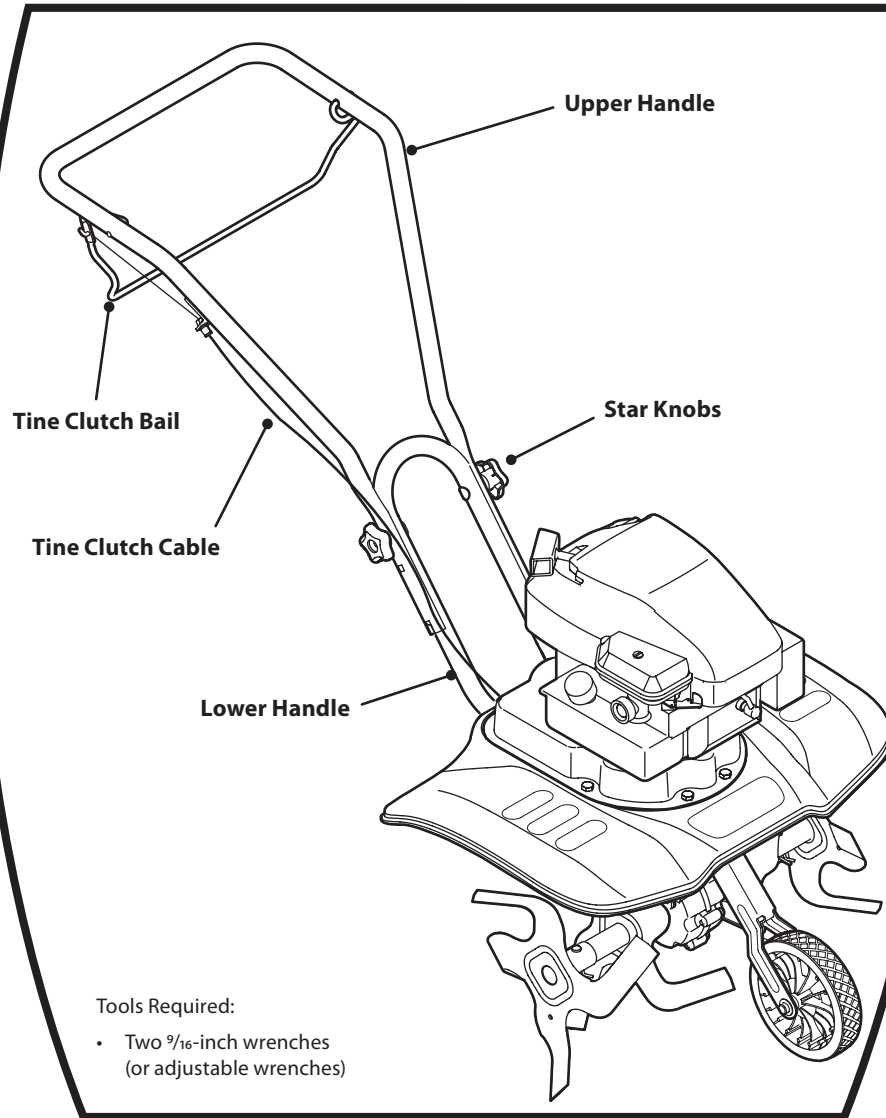

- 3 Insert the left side of the tine clutch bail into the upper handle as shown.

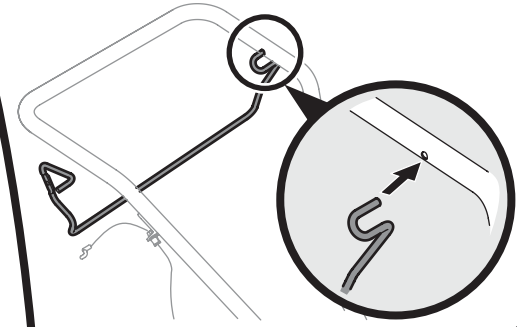

- 4 Insert the Z-fitting on the tine clutch cable into the tine clutch bail.

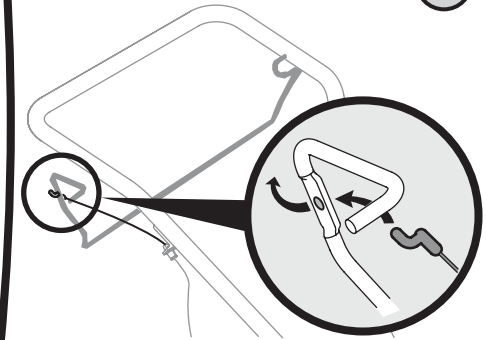

- 5 Insert the right side of the tine clutch bail into the upper handle as shown.

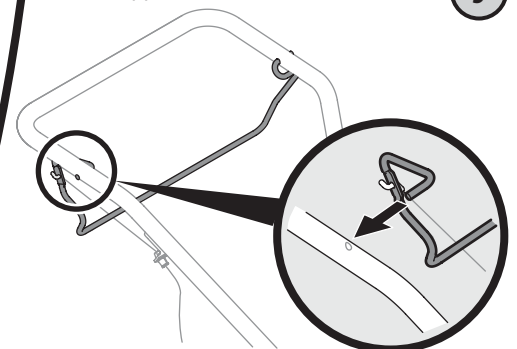

IMPORTANT: READ OPERATOR'S MANUAL AND ENGINE MANUAL THOROUGHLY AND FOLLOW THE IMPORTANT SAFE OPERATION PRACTICES BEFORE OPERATING .



Need Help? Call 1-888-TO-HELP-U



**READ AND UNDERSTAND ALL INSTRUCTION, WARNING, AND DANGER LABELS.  
PARA INSTRUCCIONES EN ESPAÑOL, REFIÉRASE AL MANUAL DEL OPERADOR.**



**6**

Remove the hex screw, flange nut, spacer and tube sleeve from the front wheel bracket.

Slide the tube sleeve over the hex screw, position the spacer within the wheel hub and secure the wheel to the wheel bracket with the flange nut previously removed.

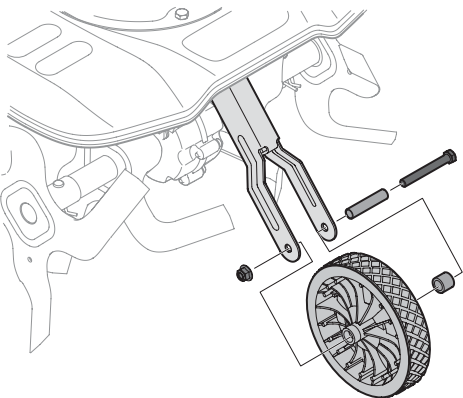

# **FAST START GUIDE**

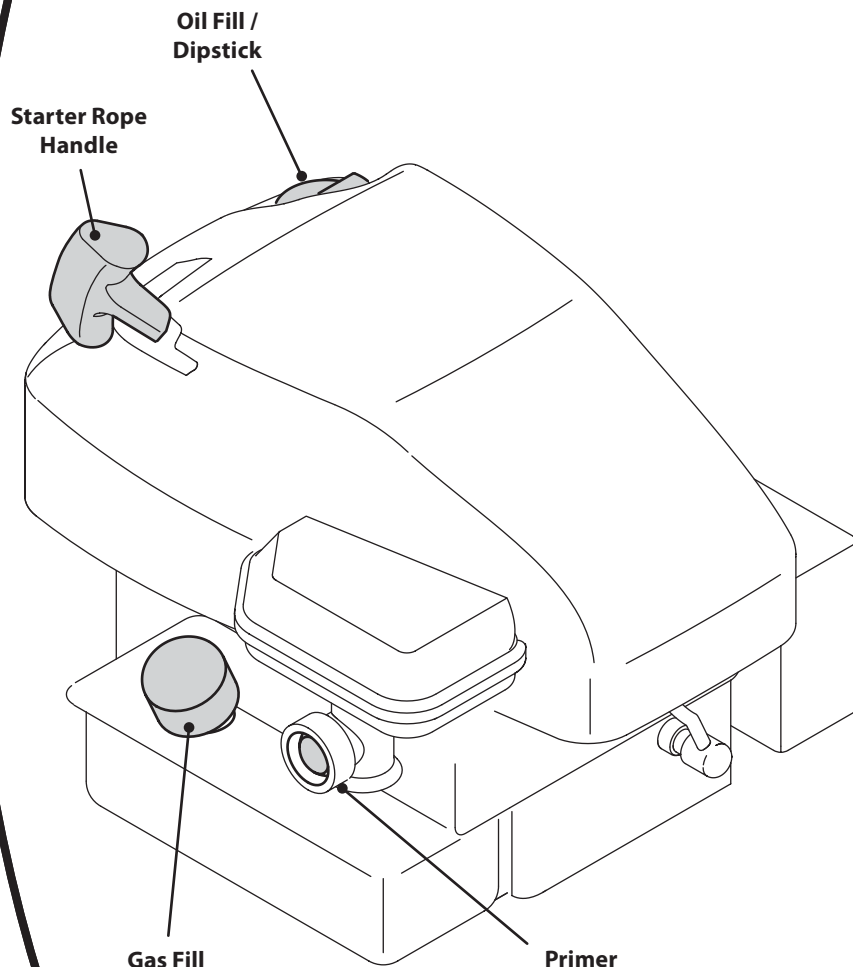

**7**

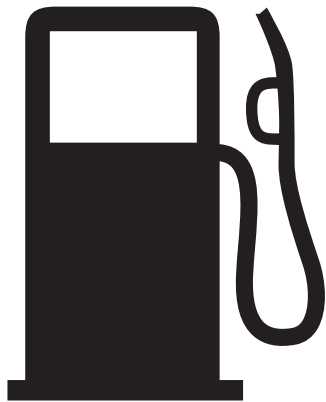

Fill fuel tank with clean, fresh gasoline. Do not fill above the base of fuel tank neck.

**8**



Pour the entire contents of the oil bottle (supplied) into the oil fill. Check the oil level using the dipstick.  
(Refer to the *Briggs & Stratton Operator's Manual*)

**9**

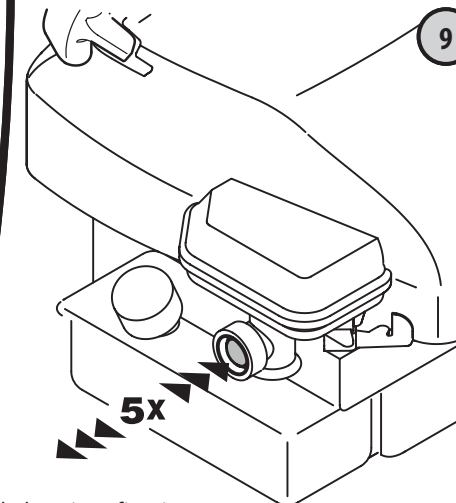

Push the primer five times.

Grasp the starter rope handle and pull with quick, full-arm stroke. If the engine does not start after five pulls, wait a few minutes and repeat step 3.



**IMPORTANT: READ OPERATOR'S MANUAL AND ENGINE MANUAL THOROUGHLY AND FOLLOW THE IMPORTANT SAFE OPERATION PRACTICES BEFORE OPERATING .**



**Need Help? Call 1-888-TO-HELP-U**