

Unpacking the Unit

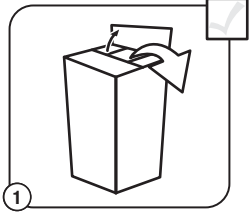

1 Remove all contents from the carton.

Assembling the Unit

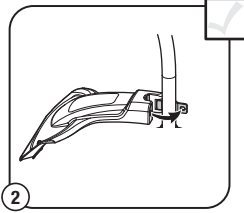

2 Insert the short tab (the one without a hole) on the mount bracket into the slot on the cutting head shield. Rotate the cutting head shield counterclockwise.

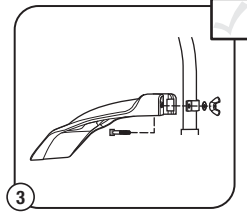

3 Insert the square bolt into the hole underneath the cutting head shield. Push the square bolt through the cutting head shield and mount bracket. Put the washer and wing nut onto the square bolt. Tighten the wing nut securely.

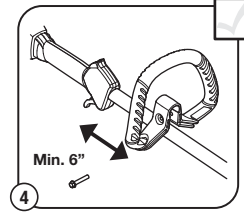

4 Push the handle onto the shaft housing. The bolt hole should be to the right. Insert the bolt into the bolt hole. Tighten the bolt, but not completely. Move the handle to the location that provides the best grip. Move the handle a minimum of 6 inches away from the shaft grip. Tighten the bolt until the handle is secure.

Assembling the Unit

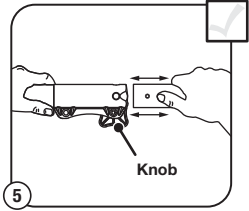

5 Remove the protective cap and gray spacer from the upper and lower shafts. Push the attachment into the coupler. Turn the knob clockwise to tighten.

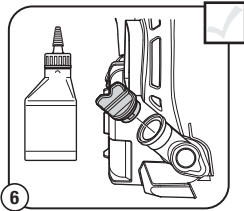

6 Set the unit on a flat, level surface. Unscrew the oil fill plug. Pour the entire bottle of oil into the oil fill hole. Reinstall the oil fill plug. **NOTE: DO NOT** overfill. Never add oil to the fuel tank. **DO NOT** mix oil with gasoline.

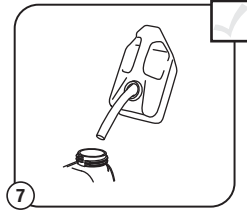

7 Place the unit on a level surface. Remove the fuel cap. Fill the fuel tank. Replace the fuel cap. Move the unit at least 30 ft. (9.1 m) from the fuel container and the fueling site before starting the engine. **NOTE: Use fresh unleaded gasoline (less than 30 days old).**

Starting the Unit

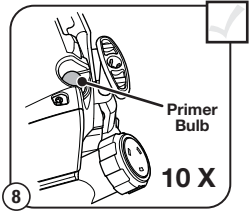

8 Press the primer bulb 10 times.

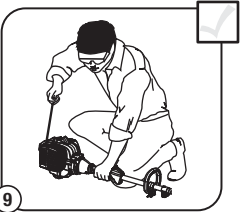

9 Crouch in the starting position.

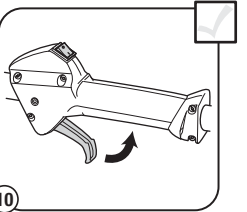

10 **SQUEEZE** and **HOLD** the throttle control.

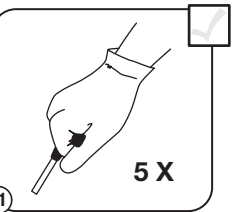

11 **Continue to squeeze the throttle control.** Pull the starter rope 5 times to start the engine.

ASSEMBLY TOOLS REQUIRED:

- 3/8" Socket

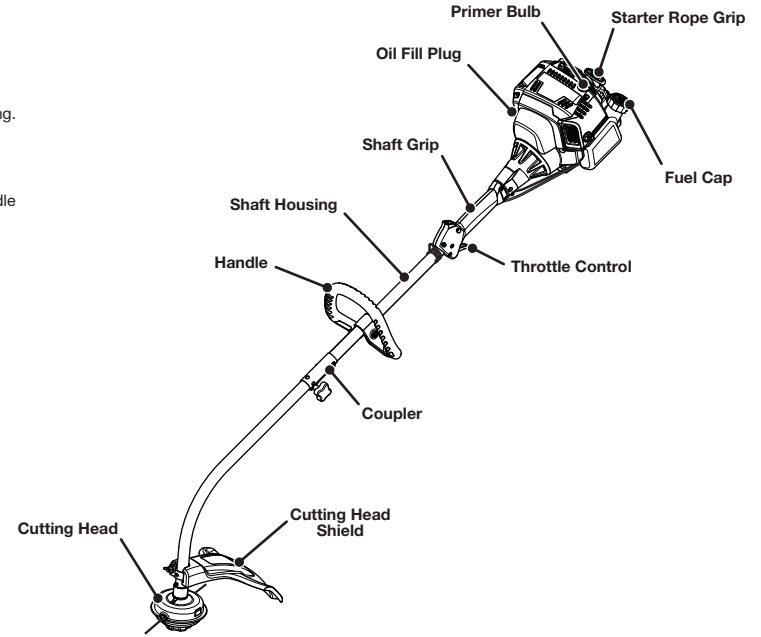

DIDN'T START?

Repeat the starting instructions.

If the unit still fails to start, refer to the operator's manual for additional starting and troubleshooting information.

Need Help?
Call 1-800-828-5500

