

Unpacking the Unit

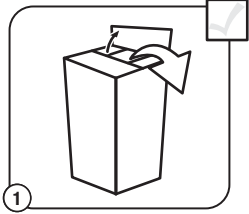

Remove all contents from the carton.

Assembling the Unit

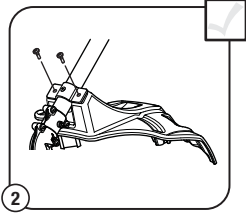

Place the cutting head shield onto the mount bracket. Screw the 2 screws through the mount bracket and into the cutting head shield. Tighten the screws equally. The gap between the mount bracket and the cutting head shield should be the same on each side.

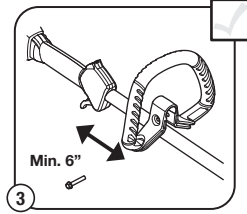

Push the handle onto the shaft housing. The bolt hole should be to the right. Insert the bolt into the bolt hole. Tighten the bolt, but not completely. Move the handle to the location that provides the best grip. Move the handle a minimum of 6 inches away from the shaft grip. Tighten the bolt until the handle is secure.

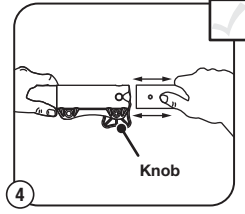

Remove the hanger cap from the attachment. If present, remove the gray spacer from the coupler. Push the attachment into the coupler. Turn the knob clockwise to tighten.

Assembling the Unit

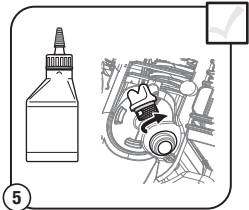

Set the unit on a flat, level surface. Unscrew the oil fill plug. Pour the entire bottle of oil into the oil fill hole. Reinstall the oil fill plug. **NOTE: DO NOT** overfill. Never add oil to the fuel tank. **DO NOT** mix oil with gasoline.

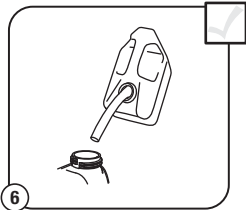

Place the unit on a level surface. Remove the fuel cap. Fill the fuel tank. Replace the fuel cap. Move the unit at least 30 ft. (9.1 m) from the fuel container and the fueling site before starting the engine. **NOTE: Use fresh unleaded gasoline (less than 30 days old).**

Starting the Unit

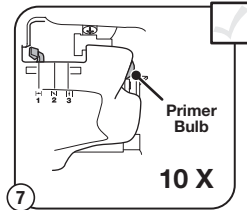

Press the primer bulb **10 X**.

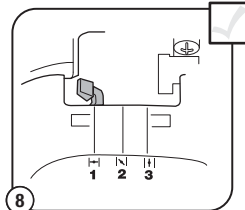

Move the choke lever to **Position 1**.

Starting the Unit

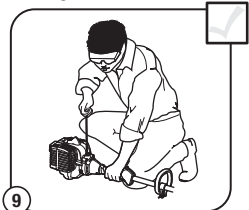

Crouch in the starting position.

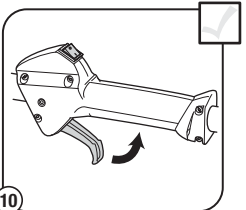

SQUEEZE and **HOLD** the throttle control for **ALL** further steps.

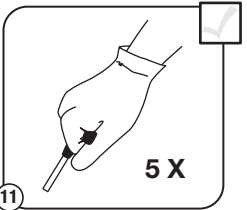

Continue to squeeze the throttle control. Pull the starter rope **5 X**.

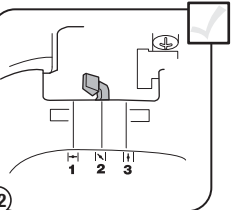

Continue to squeeze the throttle control. Move the choke lever to **Position 2**.

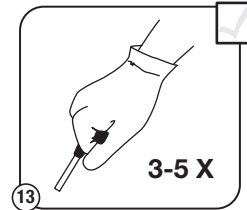

Continue to squeeze the throttle control. Pull the starter rope **3 - 5 times** to start the engine. Allow the engine to warm up for 30-60 seconds.

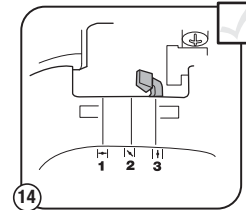

Continue to squeeze the throttle control. Move the choke lever to **Position 3**. Continue warming the engine for an additional 60 seconds. The unit may be used during this time.

ASSEMBLY TOOLS REQUIRED:

- #2 Phillips Screwdriver
- 3/8" Socket

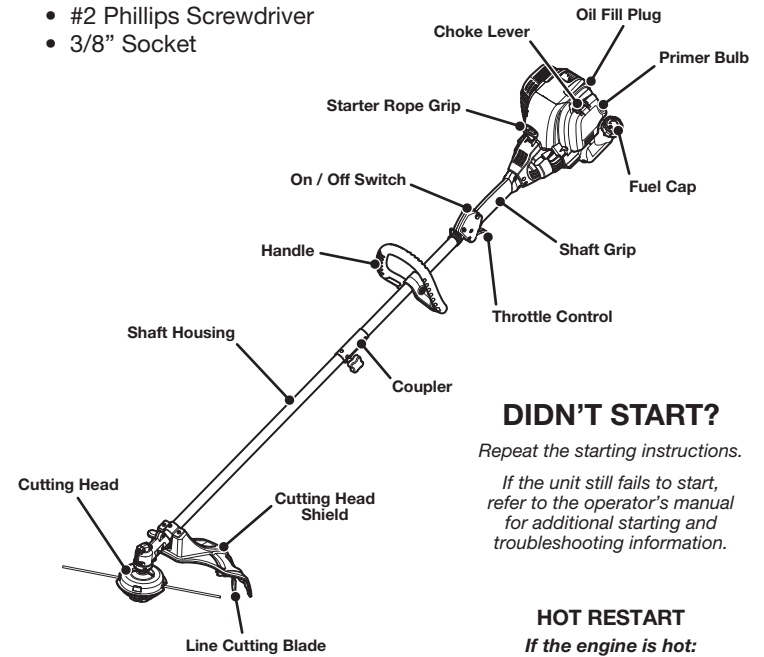

DIDN'T START?

Repeat the starting instructions.

If the unit still fails to start, refer to the operator's manual for additional starting and troubleshooting information.

HOT RESTART

If the engine is hot:

Move the choke lever to **Position 2**, press the primer bulb **10 times**, squeeze the throttle control and pull the starter rope until the unit starts. Run the unit for **2-5 minutes**. Then move the choke lever to **Position 3**.

Need Help?
Call 1-800-828-5500

