

Read the operator's manual thoroughly before operating the unit. Follow all warnings and safety instructions. This fast guide is intended as a reference for users that have already read the operator's manual and are familiar with the necessary safety precautions.

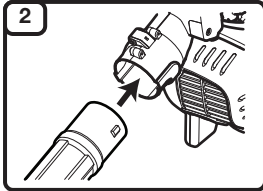

### ASSEMBLY

Align the bumps on the upper end of the upper blower tube with the slots on the blower outlet. Insert the upper blower tube into the blower outlet.

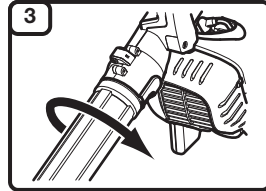

While holding the handle, twist the upper blower tube clockwise until it locks into place.  
**NOTE: Always install the upper blower tube. The lower blower tube is optional.**

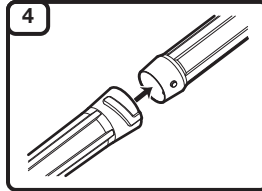

Align the slots on the lower blower tube with the bumps on the lower end of the upper blower tube. Install the lower blower tube onto the upper blower tube.

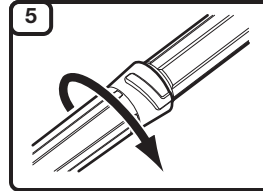

While holding the upper blower tube, twist the lower blower tube clockwise until it locks into place.

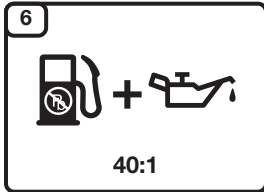

Mix thoroughly in a separate fuel can:

- 3.2 fl. oz. of 2-cycle engine oil
  - 1 gallon of fresh unleaded gasoline (**less than 30 days old**)
- NOTE:** Do not mix directly in the unit fuel tank.

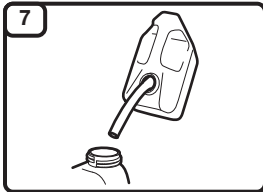

Position the unit with the fuel cap facing up. Slowly remove the fuel cap. Fill the fuel tank. Reinstall the fuel cap. Move the unit at least 30 ft. (9.1 m) from the fuel container and the fueling site before starting the engine.

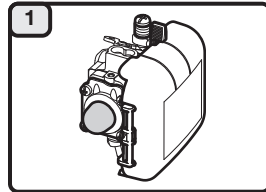

### STARTING

Slowly press and release the primer bulb **10 times**, or until fuel is visible.

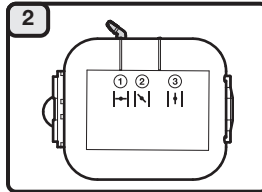

Move the choke lever to **Position 1**.

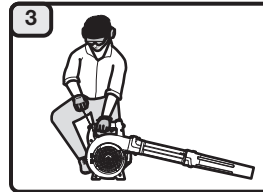

Crouch in the starting position.

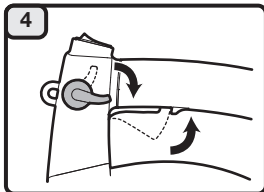

Squeeze and hold the throttle control or move the cruise control to the **HI (fast)** position.  
**NOTE: Continue to SQUEEZE and HOLD the throttle control, or keep the cruise control in the HI (fast) position, for ALL further steps.**

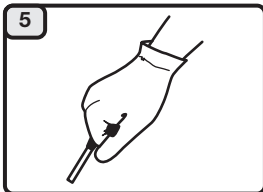

Pull the starter rope with a controlled and steady motion **5 times**.

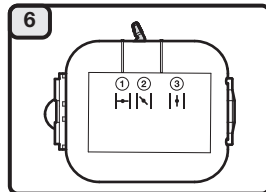

Move the choke lever to **Position 2**.

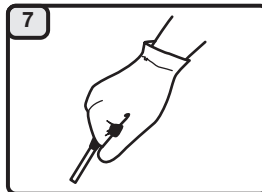

Pull the starter rope with a controlled and steady motion **3 to 5 times** to start the engine. Allow the engine to warm up for 30-60 seconds.

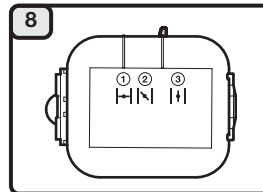

Move the choke lever to **Position 3**. Allow the engine to warm up for an additional 60 seconds. The unit may be used during this time.

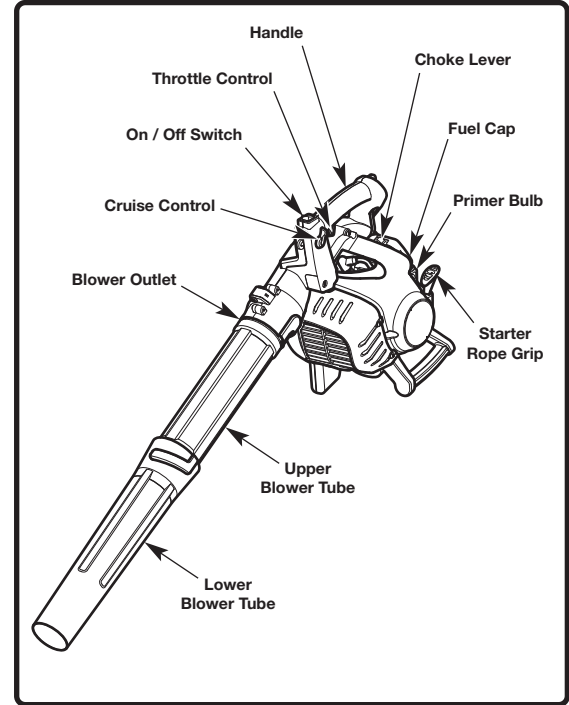

**NO ASSEMBLY TOOLS REQUIRED**

### DIDN'T START?

Repeat the starting instructions.  
If the unit still fails to start, refer to the operator's manual for additional starting and troubleshooting information.

**NOTE:** This unit includes a cruise control, which allows the operator to maintain the desired engine speed without having to squeeze the throttle control.



**IMPORTANT: READ THE OPERATOR'S MANUAL THOROUGHLY AND FOLLOW THE SAFE OPERATION PRACTICES WHILE OPERATING THE UNIT.**

Lea la traducción en Español en el manual.