

Read the operator's manual thoroughly before operating the unit. Follow all warnings and safety instructions. This fast guide is intended as a reference for users that have already read the operator's manual and are familiar with the necessary safety precautions.

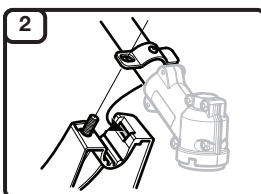

ASSEMBLY

Insert the short tab (the one without a hole) on the mount bracket into the slot on the cutting head shield. Insert the bolt on the cutting head shield into the hole on the mount bracket.

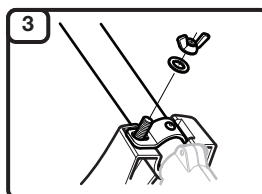

Place the washer and wing nut onto the bolt. Tighten the wing nut securely.

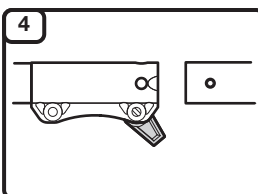

Remove the hanger cap from the attachment. If present, remove the gray spacer from the coupler. Turn the knob counterclockwise to loosen the coupler.

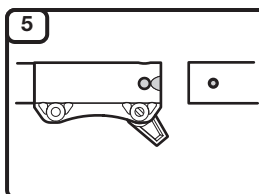

Align the release button with the guide recess. Push the attachment straight into the coupler until the release button snaps firmly into the primary hole. Turn the knob clockwise to tighten the coupler.

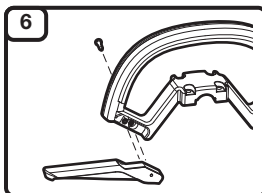

Align the two pegs on the barrier bar with the two holes in the handle. Press the barrier bar into the handle until the barrier bar snaps into place. Insert the barrier bar screw into the handle. Use a medium flat-head screwdriver or a T-20 Torx® screwdriver to tighten the barrier bar screw until the barrier bar is secure.

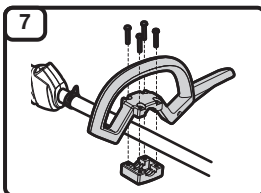

Place the handle onto the upper shaft housing. Make sure the barrier bar is on the left. Align the bottom clamp below the upper shaft housing and handle. Hold the handle and bottom clamp together. Insert the four (4) screws. Use a large flat-head screwdriver or a T-25 Torx screwdriver to tighten the screws. Do not tighten the screws completely.

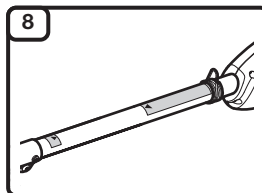

Hold the unit in the operating position. Move the handle up or down the upper shaft housing to a comfortable location. Make sure the handle is positioned between the two arrows. Tighten the screws until the handle is secure.

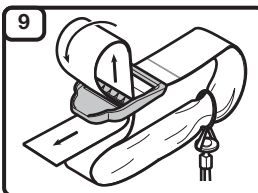

Push the strap up through the center slot in the buckle. Bend the strap over and push it down through the lower slot in the buckle. Put the shoulder strap over the operator's head and onto the left shoulder.

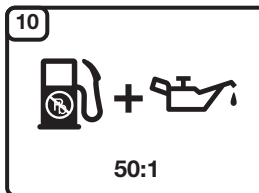

50:1

Mix thoroughly in a separate fuel can:

- 2.6 fl. oz. of 2-cycle engine oil
 - 1 gallon of fresh unleaded gasoline (**less than 30 days old**)
- NOTE:** Do not mix directly in the unit fuel tank.

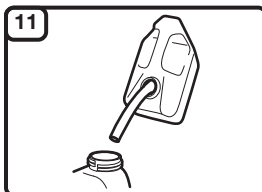

Position the unit with the fuel cap facing up. Slowly remove the fuel cap. Fill the fuel tank. Reinstall the fuel cap. Move the unit at least 30 ft. (9.1 m) from the fuel container and the fueling site before starting the engine.

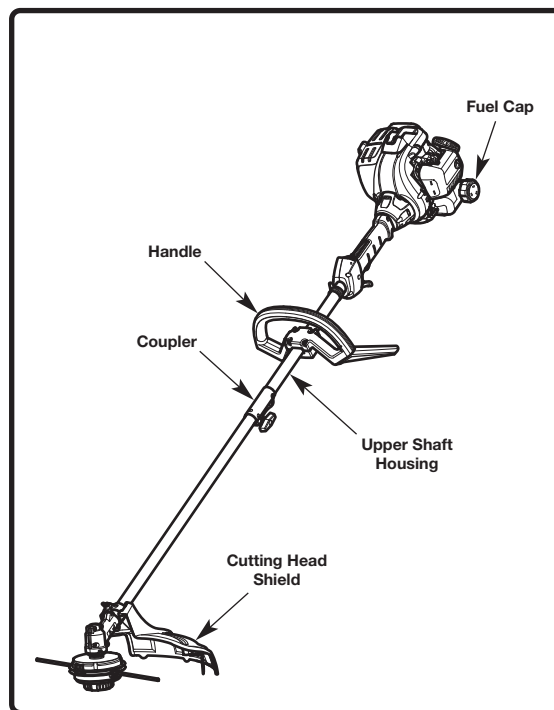

ASSEMBLY TOOLS REQUIRED

- Medium Flat-Head or T-20 Torx® Screwdriver
- Large Flat-Head or T-25 Torx Screwdriver



IMPORTANT: READ THE OPERATOR'S MANUAL THOROUGHLY AND FOLLOW THE SAFE OPERATION PRACTICES WHILE OPERATING THE UNIT.

Lea la traducción en Español en el manual.

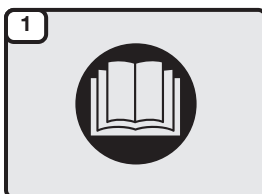

Read the operator's manual thoroughly before operating the unit. Follow all warnings and safety instructions. This fast guide is intended as a reference for users that have already read the operator's manual and are familiar with the necessary safety precautions.

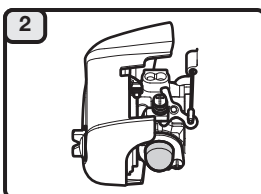

STARTING

Slowly press and release the primer bulb **10 times**, or until fuel is visible.

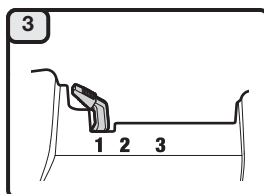

Move the choke lever to **Position 1**.



Crouch in the starting position.

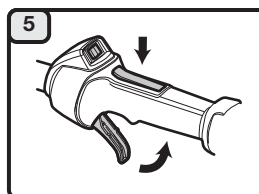

SQUEEZE and HOLD the throttle lockout and the throttle control for **ALL** further steps.

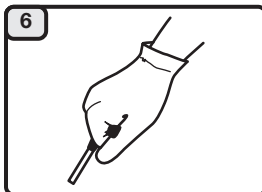

Pull the starter rope with a controlled and steady motion **5 times**.

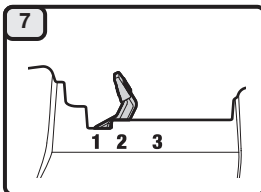

Move the choke lever to **Position 2**.

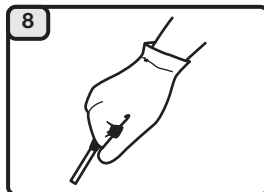

Pull the starter rope with a controlled and steady motion **3 to 5 times** to start the engine.

Allow the engine to warm up for 30-60 seconds.

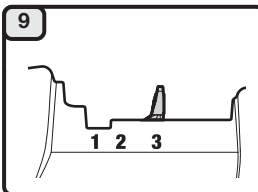

Move the choke lever to **Position 3**.

Allow the engine to warm up for an additional 60 seconds. The unit may be used during this time.

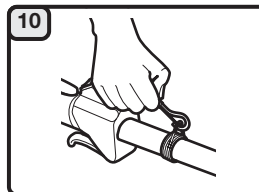

Snap the clip onto the shoulder strap loop.

Adjust the shoulder strap to fit the operator. Pull the buckle up to loosen the shoulder strap. Pull the strap down to tighten the shoulder strap.

DIDN'T START?

Repeat the starting instructions.

If the unit still fails to start, refer to the operator's manual for additional starting and troubleshooting information.

