

1
Read the operator's manual thoroughly before operating the unit. Follow all warnings and safety instructions. This fast guide is intended as a reference for users that have already read the operator's manual and are familiar with the necessary safety precautions.

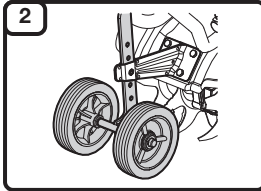

2
ASSEMBLY
Insert the wheel assembly into the wheel bracket. The "J" shape of the wheel assembly should point away from the unit.

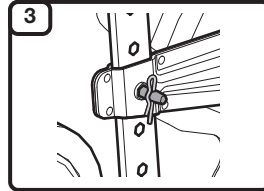

3
Align the hole in the bracket with the desired hole in the assembly. Insert the clevis pin through the aligned holes. Insert the cotter pin into the clevis pin.
NOTE: It may be necessary to adjust the position of the wheel assembly before using the unit.

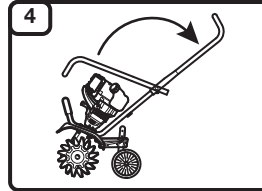

4
Set the unit upright. Loosen the knobs. Swing the handlebar up into the operating position.
NOTE: Take care not to pinch the cables when positioning the handlebar.

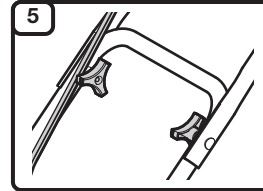

5
Tighten the knobs securely. Readjust the cables so they are smooth and tight against the handlebar.
NOTE: Do not over tighten the knobs.

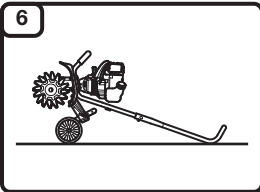

6
Set the unit on a flat, level surface. Tip the unit back so that the handlebar touches the ground and the engine is in a horizontal position.

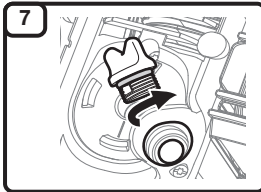

7
Unscrew the oil fill plug. Pour the entire container of oil into the oil fill hole. Reinstall the oil fill plug.
NOTE: DO NOT overfill. Never add oil to the fuel tank. **DO NOT** mix oil with gasoline.

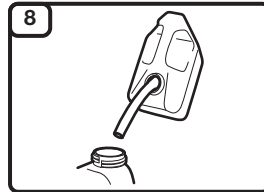

8
Slowly remove the fuel cap. Fill the fuel tank. Reinstall the fuel cap. Move the unit at least 30 ft. (9.1 m) from the fuel container and the fueling site before starting the engine.
NOTE: Use fresh unleaded gasoline (less than 30 days old).

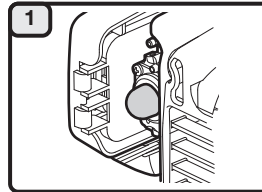

1
STARTING
PRIME:
Slowly press and release the primer bulb 10 times, or until fuel is visible.

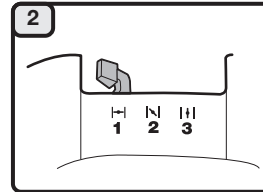

2
PRIME:
Move the choke lever to Position 1.

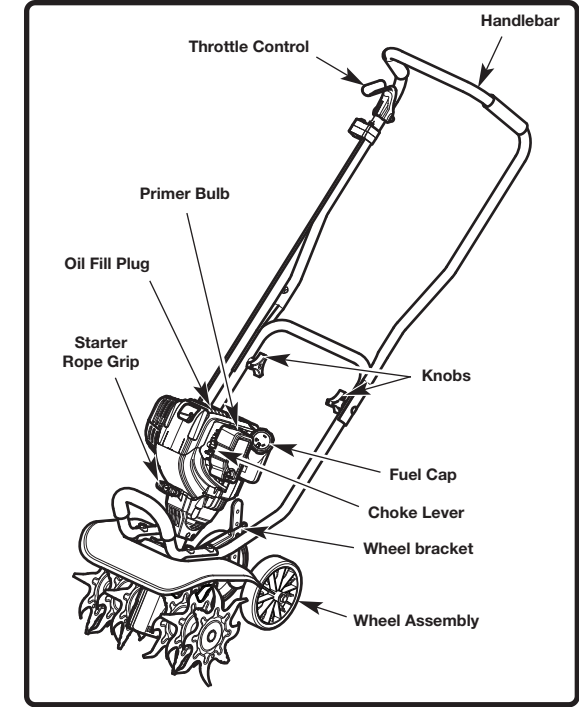

NO ASSEMBLY TOOLS REQUIRED

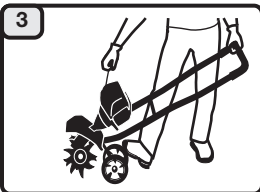

3
PRIME:
Stand in the starting position. Hold the handlebar firmly with one hand. Hold the starter rope with the other hand. Use one foot to hold the wheels in place. Tilt the unit back slightly to bring the tines off the ground.

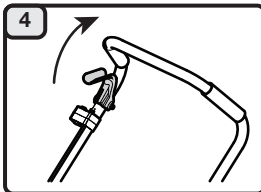

4
PRIME:
Squeeze and hold the throttle control.
NOTE: Continue to SQUEEZE and HOLD the throttle control for ALL further steps.

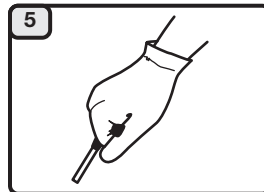

5
PRIME:
Pull the starter rope with a controlled and steady motion 5 times.
DO NOT pull the starter rope more than 5 times.

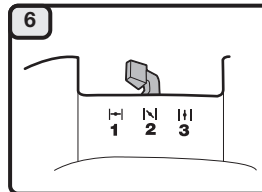

6
START:
Move the choke lever to Position 2.

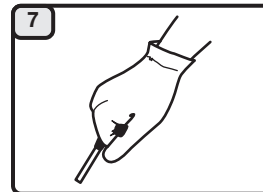

7
START:
Pull the starter rope with a controlled and steady motion 5 to 10 times to start the engine. Allow the engine to warm up for 60 seconds.

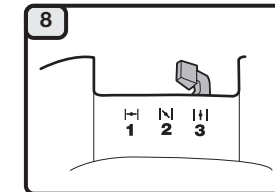

8
START:
Move the choke lever to Position 3. Allow the engine to warm up for an additional 60 seconds. The unit may be used during this time.

DIDN'T START?
Repeat the starting instructions. If the unit still fails to start, refer to the operator's manual for additional starting and troubleshooting information.



IMPORTANT: READ THE OPERATOR'S MANUAL THOROUGHLY AND FOLLOW THE SAFE OPERATION PRACTICES WHILE OPERATING THE UNIT.

Lea la traducción en Español en el manual.